

"Le Grande"



Premium Residential Apartments

An Artist Impression of Le Grande, Alld.

LOCATION AND SITE PLAN OF "Le Grande"

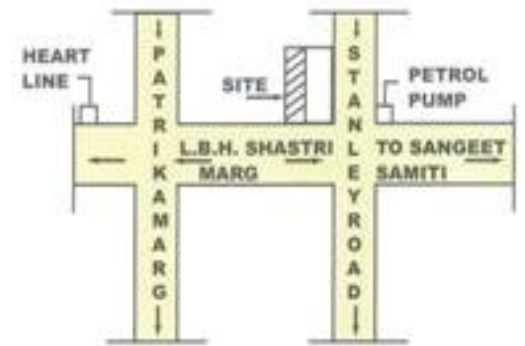

KEY PLAN (NTS)

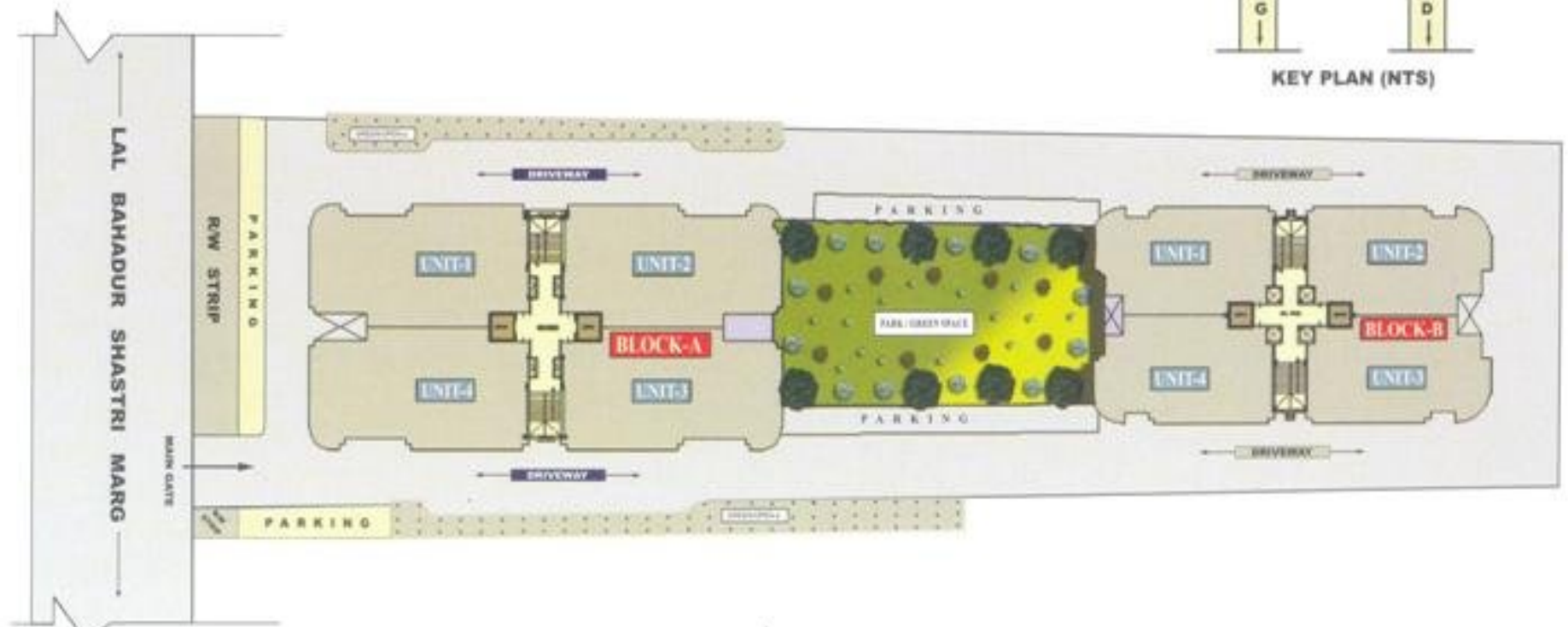

**BLOCK-A
(4BHK+SERVANT)**



UNIT-1

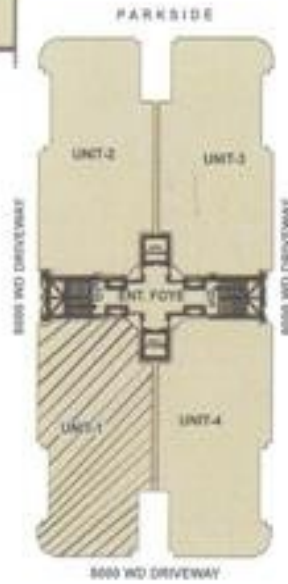

**KEY PLAN
N.T.S.**



UNIT-4

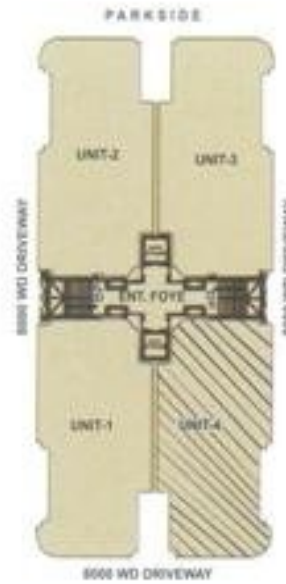

**KEY PLAN
N.T.S.**

- A) COVERED AREA OF UNIT=177.94 SQM OR 1915.35 SFT
- B) BUILT UP AREA OF UNIT (INC. BAL.)=209.03 SQM OR 2250.00 SFT
- C) SUPER BUILT UP AREA OF UNIT=228.57 SQM OR 2460.33 SFT

- A) COVERED AREA OF UNIT=177.94 SQM OR 1915.35 SFT
- B) BUILT UP AREA OF UNIT (INC. BAL.)=209.03 SQM OR 2250.00 SFT
- C) SUPER BUILT UP AREA OF UNIT=228.57 SQM OR 2460.33 SFT



UNIT-2

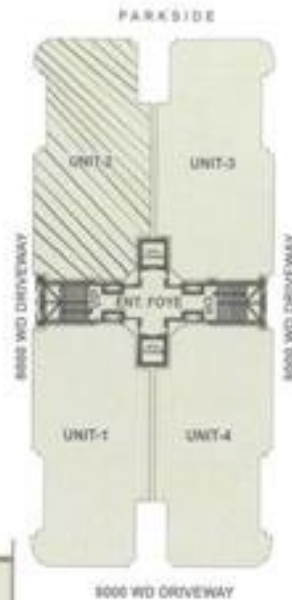

**KEY PLAN
N.T.S.**

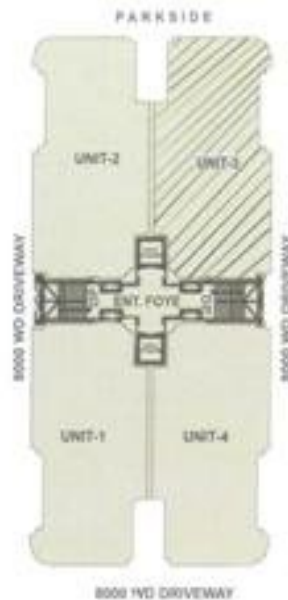

**KEY PLAN
N.T.S.**

**BLOCK-A
(4BHK+SERVANT)**



UNIT-3

- A) COVERED AREA OF UNIT=177.94 SQM OR 1915.35 SFT
- B) BUILT UP AREA OF UNIT (INC. BAL.)=209.03 SQM OR 2250.00 SFT
- C) SUPER BUILT UP AREA OF UNIT=228.57 SQM OR 2460.33 SFT

- A) COVERED AREA OF UNIT=177.94 SQM OR 1915.35 SFT
- B) BUILT UP AREA OF UNIT (INC. BAL.)=209.03 SQM OR 2250.00 SFT
- C) SUPER BUILT UP AREA OF UNIT=228.57 SQM OR 2460.33 SFT

**BLOCK-B
(3BHK)**



UNIT-1

KEY PLAN



KEY PLAN

UNIT-4

- A) COVERED AREA OF UNIT=129.20 SQM OR 1390.71 SFT
- B) BUILT UP AREA OF UNIT (INC. BAL.)=153.37 SQM OR 1650.87 SFT
- C) SUPER BUILT UP AREA OF UNIT=171.10 SQM OR 1841.72 SFT

- A) COVERED AREA OF UNIT=129.20 SQM OR 1390.71 SFT
- B) BUILT UP AREA OF UNIT (INC. BAL.)=153.37 SQM OR 1650.87 SFT
- C) SUPER BUILT UP AREA OF UNIT=171.10 SQM OR 1841.72 SFT

BLOCK-B (3BHK)

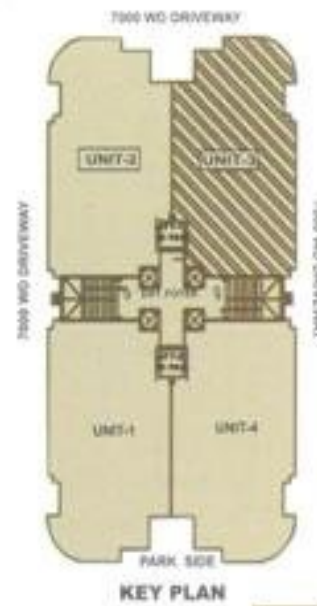

- A) COVERED AREA OF UNIT=129.20 SQM OR 1390.71 SFT
- B) BUILT UP AREA OF UNIT (INC. BAL.)=153.37 SQM OR 1650.87 SFT
- C) SUPER BUILT UP AREA OF UNIT=171.10 SQM OR 1841.72 SFT

- A) COVERED AREA OF UNIT=129.20 SQM OR 1390.71 SFT
- B) BUILT UP AREA OF UNIT (INC. BAL.)=153.37 SQM OR 1650.87 SFT
- C) SUPER BUILT UP AREA OF UNIT=171.10 SQM OR 1841.72 SFT

“SPECIFICATION”

S.NOS.		
A	STRUCTURE	Earthquake resistant r.c.c. framed structure
B	FLOOR FINISHES	
	Living / Dinning / LOBBY	Vitrified tiles
	Bedrooms	Vitrified tiles
	Stairs	Stone flooring on treads
	Balconies	Non - skid ceramic tiles
C	TOILETS	
	Flooring	Non - skid ceramic tiles / vitrified tiles
	Walls	Vitrified tiles (up to 8')
	Sanitaryware fitting	Hindware / cera / equivalent
	fitting	Single lever CP fittings
	Water Supply	Provisions for hot and cold water supply
D	KITCHEN	
	Flooring	Vitrified tiles
	Dado	Ceramic tiles cladding on walls as per architecture design
	Counter	Granite
	Water Supply	Provision for hot and cold water supply
	Fittings	Single level CP fittings with mixers
	Sink	Stainless sink with drain board
E	JOINERY	
	Windows	Anodised aluminium with toughened glass
	Doors	(A) ISI. mkd. veneer pasted flush door with s.w. chaukhat (B) Main entrance door shall be a panel door
F	PAINTING	
	Internal	All wall surfaces shall be finished with plastic emulsion paint as per design
	External	Pleasing elevation with semi - permanent finish / all weather proofing exterior paints
G	OTHER FEATURES	
	Electrical	Copper wiring in conduits with modular switches
	Telecommunication	Provision of telephone points in drawing room, dinning room and all bedrooms
		Provision of TV aerial points in drawing room/ lobby and all bedrooms
H	OTHERS	
		Videophone at main entrance door, Exhaust fans in all bathrooms shall be provided. Intercom between security and each flat, water purifier in the
		kitchen.

Disclaimer : All details/specifications/impressions are indicative based on available information and are subject to change.



DEVELOPERS :- VINAYAK GRAND PROJECTS
REGD. OFFICE :- THE GRAND CONTINENTAL HOTEL
S.P. MARG ALLAHABAD
TEL. Ph- 0532-2260630-35, Mob. 9793003888
E-mail : vinayakgrandprojects@gmail.com

An Artist Impression of Le Grande, Alld.

Consultant

Mob. : +91-9415214329

AKHILESHWAR SINGH
B.Arch., M.E.
C.O.A.

ARCONS



ARCHITECT, ENGINEER
INTERIOR DESIGNER
& VALUER

Off. - Shop No. 05, Lotus Apartment, Taskand Marg, Alld.
E-mail : writetoarcons@gmail.com